

PR-2

Multi-Task Welding System

Multi-Task Welder Features:

- ✓ Spot hammer dent pulling
- ✓ Stitch welding
- ✓ Carbon shrinking
- ✓ Contact shrinking
- ✓ Nut and bolt welding
- ✓ Washer welding
- ✓ Nail welding
- ✓ Moulding clip rivet welding
- ✓ Pro Pull dent pulling (optional)
- ✓ Lever bar dent pulling (optional)
- ✓ Built-in MIG welder available (optional)

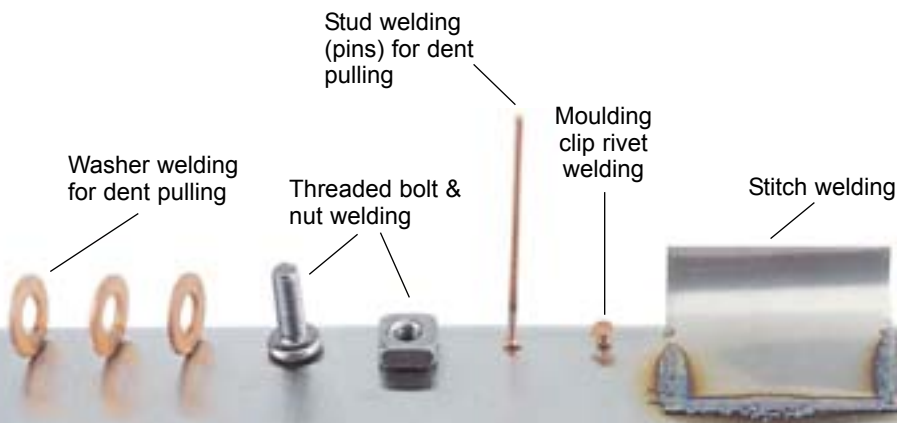

Spot hammer welding



PR-2 Dent Pulling Accessories



Quickest dent pulling system ever! Just weld on the hammer directly on the dent and hammer away. Simply twist to release. (magnetic ground plate optional)



Ideal for rust repair and patching, stitch welding works by delivering an intermittent or pulsating current while rolling the tip along the sheet metal edge.



Lever bar (optional)

Spot hammer

Slide hammer with hook (optional)

Weld-on shaft with collar (optional)

Hammer weight (optional)



Pro Pull Dent Pulling. Position the weld tip in the bottom of the dent, weld, then squeeze the handle to initialize the pulling action.



Lever bar welding. Simply weld on the shaft to the dent and pull the lever to straighten.



Pro Pull® Dent Removal System (optional)

Single-Sided Gun

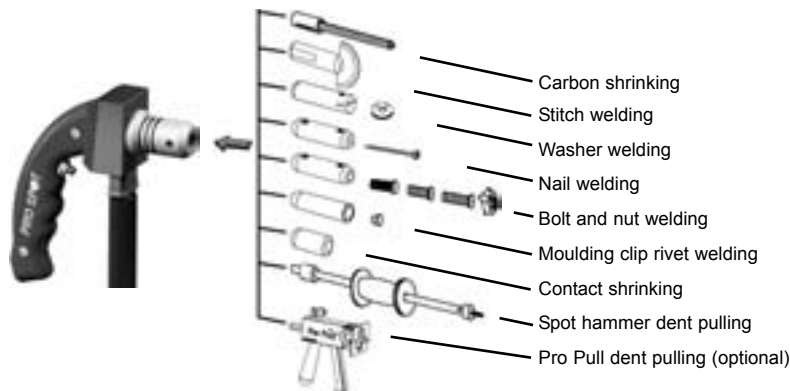

- Carbon shrinking
- Stitch welding
- Washer welding
- Nail welding
- Bolt and nut welding
- Moulding clip rivet welding
- Contact shrinking
- Spot hammer dent pulling
- Pro Pull dent pulling (optional)

Pro Pull® Dent Removal System

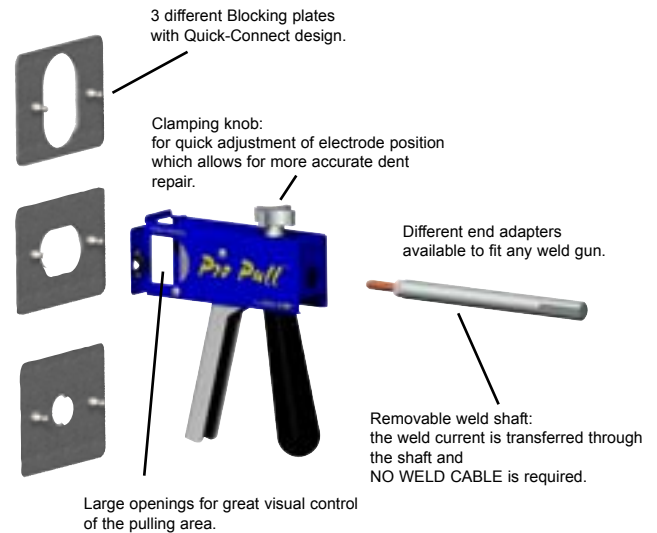

3 different Blocking plates with Quick-Connect design.

Clamping knob: for quick adjustment of electrode position which allows for more accurate dent repair.

Different end adapters available to fit any weld gun.

Removable weld shaft: the weld current is transferred through the shaft and NO WELD CABLE is required.

Large openings for great visual control of the pulling area.

Technical Talk ...

PR-2 Multi-task welder:

Input voltage:	208-230V or 400V 1 phase
Input cable:	30' (9.1m)
Output amperage:	2000A max. (at electrodes)
Welding cable:	7' (2.1m)
Cooling System:	Air (1 fan)
Weight:	92Lb. (43kg)

Adjustable current and weld time
9 different weld functions

Pro Spot International, Inc. U.S.A.

Toll Free: 877-PRO SPOT

Phone: 760-789-1380

Fax: 760-489-1531

E-mail: info@prospot.com

WEB: www.prospot.com

